

XST6238TR 1.125 – COMPLIANT SHOWER

Without Seat

Interior: 60 x 36 x 76 ¾

Exterior: 66 x 38 ⅛ x 78 ¾

inches

The XST6238TR1.125 roll-in shower features innovative installation design, including an engineered leveled base and improved front threshold with molded integral linear trench drain. A true time and money saver, our pre-leveled base lets you install directly on a **level** floor. And its front threshold is engineered to keep a constant level with the innovative nailing flange.

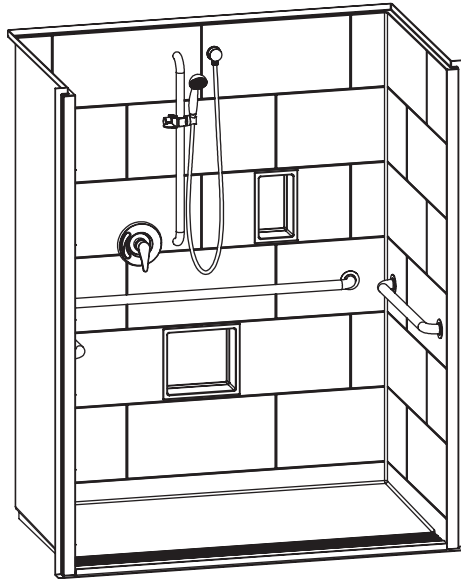

Shown fully-equipped

COLOR & TRIM OPTIONS

| Stock | Upgraded |
|-------|-----------------|
| White | Biscuit Bone |

**Additional custom colors available.
(Contact Customer Service)

FEATURES

- Pre-leveled base
- AcrylX™ applied acrylic surface
- 1 ⅛" skirt
- Barrier free when properly installed
- Smooth subway tile wall
- Center front drain outlet
- Integral front trench drain
- 30-year warranty*

* See terms and conditions for details

OPTIONS

- Grab bars
- Hand-held shower assembly with slide bar
- Pressure balancing mixing valve
- Large soap dish
- Small soap dish
- Curtain rod and/or shower curtain, shipped loose

CODE COMPLIANCE

- ADA
- FHA
- HUD UM73a
- ANSI Z124.1.2
- CAN/CSA-B45-02

**Code compliant when fully equipped and installed according to guidelines.

XST6238TR 1.125

Without Seat

Interior: 60 x 36 x 76 ¾
Exterior: 66 x 38 ⅛ x 78 ¾
inches

ADA compliant when fully equipped and installed according to guidelines.

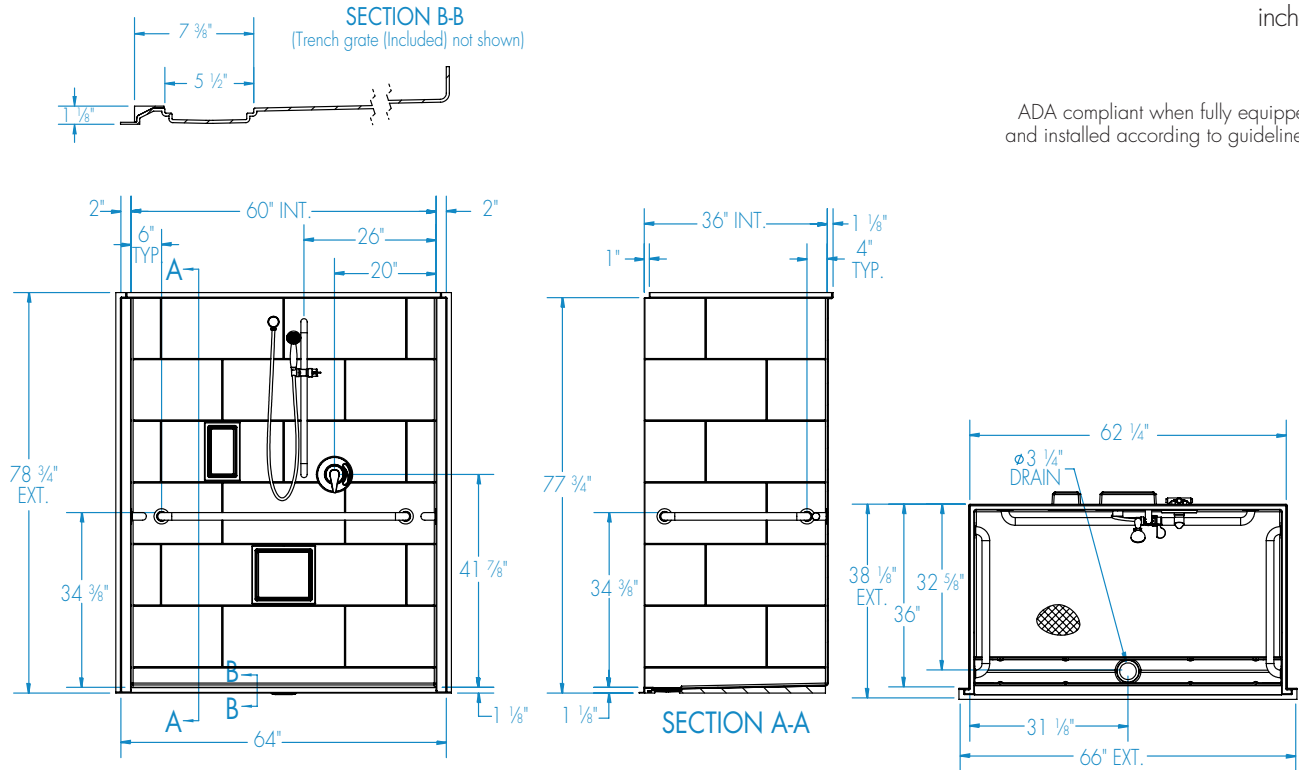

FEATURES

Ibs

Dimensional Tolerance $\pm \frac{3}{8}$ ". Dimensions needed for site preparation should be measured from the unit. Manufacturer assumes no responsibility for preparatory work.

| Type and Model # | Material | Wall Finish | Pieces | Drain | Dam/Skirt Height | Net Wt. | Pkg. Wt. |
|------------------------|--------------------------|-------------|--------|--------------|------------------|---------|----------|
| Shower XST6238TR 1.125 | Acrylix™ applied acrylic | Smooth tile | 1 | Center Front | 1 ½ skirt | 200 | 210 |

DIMENSIONS

| Specifications | inches |
|---------------------------------|-------------|
| Width: Ext. / Int. | 66 / 60 |
| Depth: Ext. / Int. | 38 ⅛ / 36 |
| Height: Ext. / Int. | 78 ¾ / 76 ¾ |
| Enclosure Opening: | 60 |
| Skirt Height: | ½ |
| Drain Rough-In (from Back Wall) | 32 ⅝ |
| Drain Rough-In (from Side Wall) | 31 ⅛ |

FRAMING DIMENSIONS

| Type | D Depth | W Width | H Height | A | B | C |
|--------|------------|------------|-------------|---------|------|------|
| Alcove | 36 | 62 ¼ | - | Box Out | 31 ⅛ | 32 ⅝ |

