

XST3838TR 1.125

With Seat • ANSI Compliant

Interior: 36 x 36 x 76 ¾

Exterior: 42 x 38 ⅞ x 78 ¾

inches



ANSI compliant when fully equipped and installed according to guidelines.

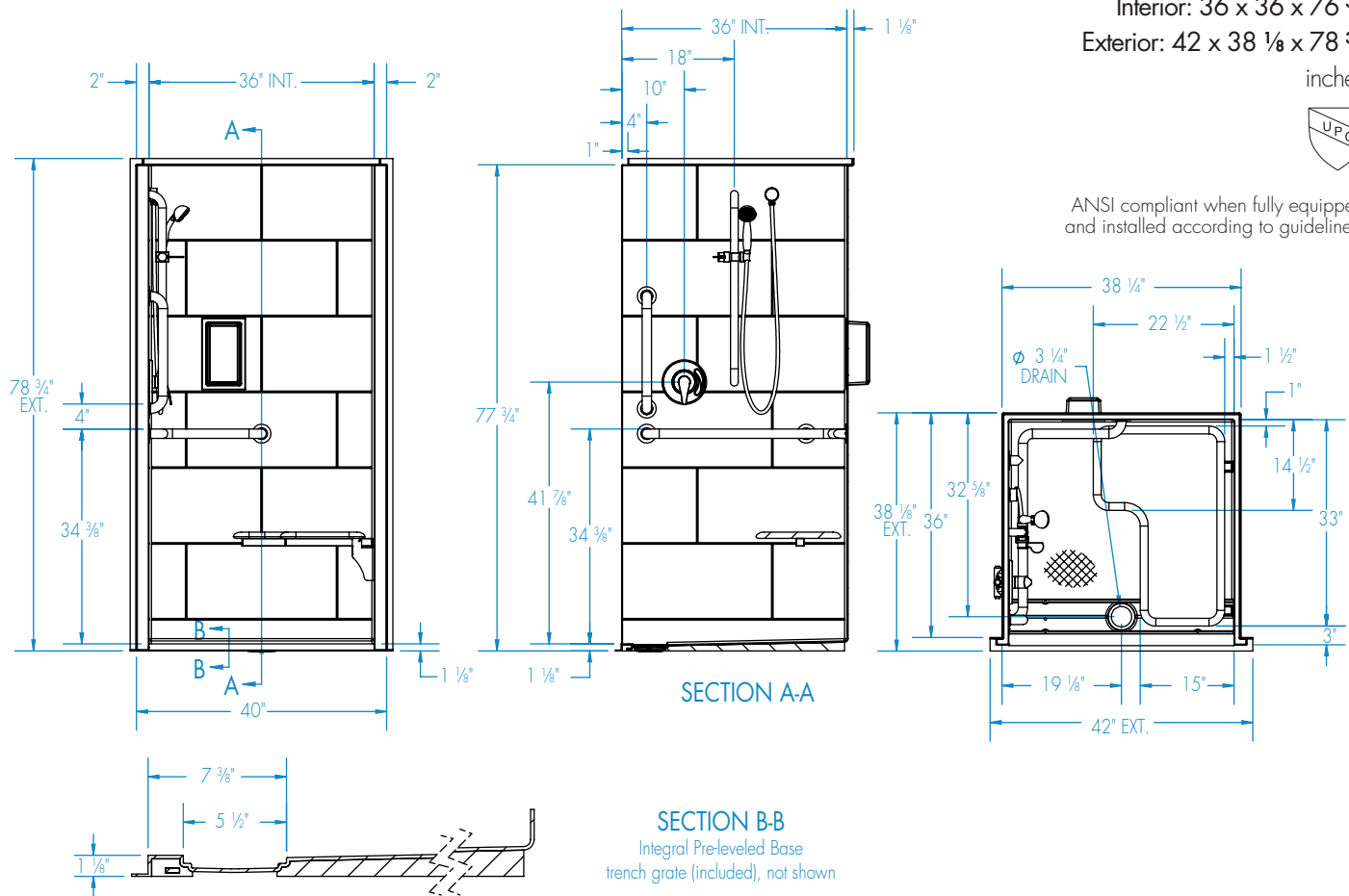

FEATURES lbs Dimensional Tolerance $\pm \frac{3}{8}$ ". Dimensions needed for site preparation should be measured from the unit. Manufacturer assumes no responsibility for preparatory work.

Type and Model #	Material	Wall Finish	Pieces	Drain	Dam/Skirt Height	Net Wt.	Pkg. Wt.
Shower XST3838 TR1.125	AcrylX™ applied acrylic	Smooth tile	1	Center Front	1 ⅞" skirt	140	150

DIMENSIONS

Specifications	inches (mm)
Width: Ext. / Int.	42 / 36
Depth: Ext. / Int.	38 ⅞ / 36
Height: Ext. / Int.	78 ¾ / 76 ¾
Enclosure Opening:	36
Skirt Height:	1 ⅞
Drain Rough-In (from Back Wall)	32 ⅝
Drain Rough-In (from Side Wall)	19 ⅞

FRAMING DIMENSIONS inches (mm)

Type	D Depth	W Width	H Height	A	B	C
Alcove	36	38 ¼	-	Box Out	19 ⅞	32 ⅝

